

Friday, February 13, 2009

Boyd's Creek Hwy, TN
Sevier County, TN parcel# 035 016.01

Property Report

Location

Property Address	Boyd's Creek Hwy TN
Subdivision	
County	Sevier County, TN

Current Owner

Name	Meza Tina
Mailing Address	402 Meadowlake Cir Seymour, TN 37865-4969

Property Summary

Property Type	Residential
Land Use	Household Unit
Improvement Type	
Total Square Feet	

General Parcel Information

Parcel/Tax ID	035 016.01
Special Int	000
Alternate Parcel ID	
Land Map	035
District/Ward	09
Census Tract/Block	

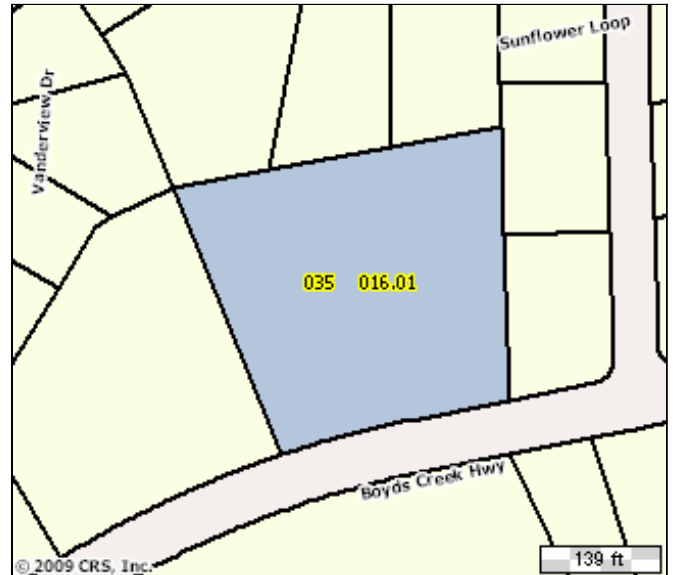

Sales History through 02/06/2009

Date	Amount	Buyer/Owners	Buyer/Owners 2	Instrument	Quality	Book/Page or Document#
06/16/2006	\$79,900	Meza Tina				2554/529
06/05/1995	\$16,000			Multiple Parcels Sold	Disqualified	549/454
06/06/1985						351/217

Tax Assessment

Appraisals	Amount	Taxes	Amount	Jurisdiction	Rate
Tax Year	2008	City Taxes	\$0	Sevier	1.54
Appraised Land	\$37,500	County Taxes	\$144.38		
Appraised Improvements	\$0	Total Taxes	\$144.38		
Total Tax Appraisal	\$37,500	Exempt Amount			
Total Assessment	\$9,375	Exempt Reason			

Mortgage History

No mortgages were found for this parcel.

Property Characteristics: Building

No Buildings were found for this parcel.

Property Characteristics: Extra Features

No extra features were found for this parcel.

Property Characteristics: Lot	
Land Use	Household Unit
Lot Dimensions	
Acreage	2.18
Block/Lot	
Latitude/Longitude	35.894244°/-83.719143°

Property Characteristics: Utilities/Area			
Gas Source	None	Road Type	St Highway
Electric Source	Public	Topography	Rolling
Water Source	Public	District Trend	Improving
Sewer Source	Individual	Special School District 1	0
Zoning Code		Special School District 2	0
Owner Type	Private		

Legal Description			
Subdivision		Plat Book/Page	
Block/Lot		Description:	